

Rückschlagklappe, metallisch dichtend, mit Hebel und Gewicht / Check valve, metal seated, with lever and counterweight PA-4250.127 / PA-4250.126

Technische Daten

Bauform	Specification
Flanschen Rückschlagklappe	<i>Design</i> Check valve with flanges
Innenliegende Welle	Inside stem
Baulänge nach EN 558-1 Gr 48 (F6)	Face to face acc. to EN 558-1 series 48 (F6)
DN 50 - 150: PN 16	DN 50 - 150: PN 16
DN 200 - 600: PN 10 oder PN 16	DN 200 - 600: PN 10 or PN 16

Typ PA-4250.127	Type PA-4250.127
Gehäuse: GGG-50, EKB-Beschichtung min 250µm entsprechend GSK	Body: GGG-50, EKB—coating min 250µm according to GSK
Sitz: Bronze	Seat: bronze
Welle: AISI 420	Shaft: AISI 420
Klappensitz: AISI 420	Obturator: AISI 420

Typ PA-4250.126	Type PA-4250.126
Gehäuse: GGG-50, EKB-Beschichtung min 250µm entsprechend GSK	Body: GGG-50, EKB—coating min 250µm according to GSK
Sitz/Welle/Klappensitz: Edelstahl AISI 316	Seat/Shaft/Obturator: Stainless steel AISI 316

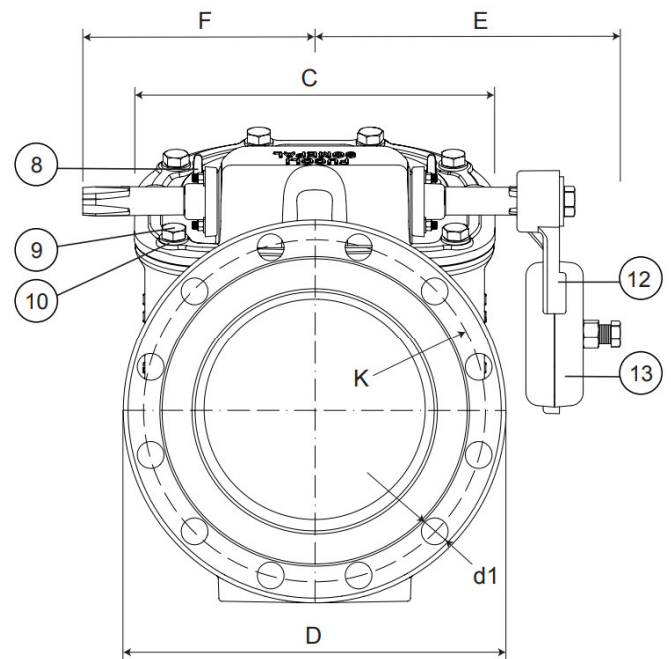
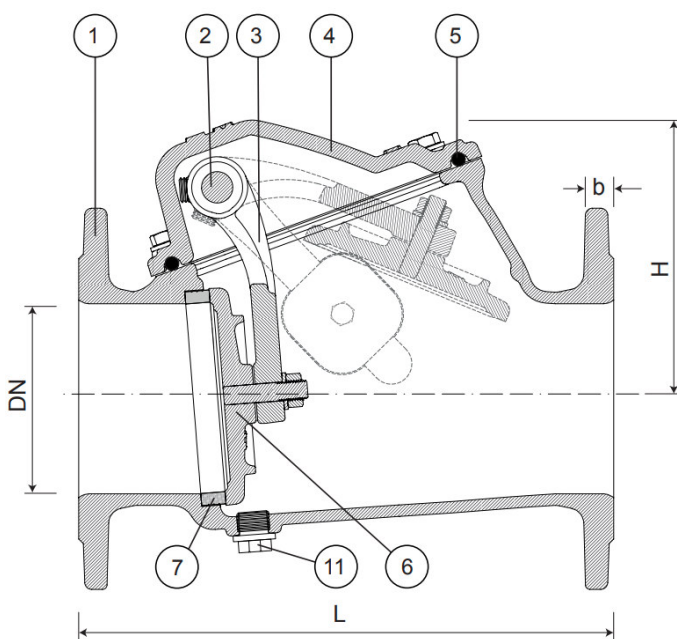

DN	D		C	E	F	L	H	Anzahl und Ø der Löcher		Gewicht	
	PN 10	PN 16						PN 10	PN 16	PN 10	PN 16
50	165	165	110	138	104	200	108	125Ø - 4 x 19Ø	125Ø - 4 x 19Ø	10,2	10,2
60	175	175	123	148	115	240	119	135Ø - 4 x 19Ø	135Ø - 4 x 19Ø	11,9	11,9
65	185	185	123	148	115	240	119	145Ø - 4 x 19Ø	145Ø - 4 x 19Ø	12,7	12,7
80	200	200	140	166	122	260	137	160Ø - 8 x 19Ø	160Ø - 8 x 19Ø	15,8	15,8
100	220	220	168	175	135	300	157	180Ø - 8 x 19Ø	180Ø - 8 x 19Ø	22,0	22,0
125	250	250	215	205	155	350	186	210Ø - 8 x 19Ø	210Ø - 8 x 19Ø	33,5	33,5
150	285	285	242	220	170	400	210	240Ø - 8 x 23Ø	240Ø - 8 x 23Ø	45,6	45,6
200	340	340	295	250	200	500	242	295Ø - 8 x 23Ø	295Ø - 12 x 23Ø	64,3	64,3
250	400	400	377	287	232	600	296	350Ø - 12 x 23Ø	355Ø - 12 x 28Ø	97,0	97,0
300	455	455	427	310	260	700	325	400Ø - 12 x 23Ø	410Ø - 12 x 28Ø	143,0	143,0
350	505	520	480	340	280	800	400	460Ø - 16 x 23Ø	470Ø - 16 x 28Ø	151,0	157,5
400	565	580	531	387	330	900	435	515Ø - 16 x 28Ø	525Ø - 16 x 31Ø	281,2	290,2
450	615	640	585	394	337	1000	460	565Ø - 20 x 28Ø	585Ø - 20 x 31Ø	391,0	406,0
500	670	715	640	422	365	1100	485	620Ø - 20 x 28Ø	650Ø - 20 x 34Ø	420,0	445,0
600	780	840	750	477	420	1300	585	725Ø - 20 x 31Ø	770Ø - 20 x 37Ø	620,0	670,0

Bezeichnung	Material
Body	EN-GJS-500-7 (GGG-50)
Bonnet	EN-GJS-500-7 (GGG-50)
Obturator	Stainless Steel AISI 420 / AISI 316
Body Seat	Bronze CuSn7Zn4Pb7 / AISI 316
Bonnet Gasket	Elastomer EPDM with CE marking
Arm	EN-GJS-500-7 (GGG-50)
Shaft	Stainless Steel AISI 420 / AISI 316
Lever	EN-GJS-500-7 (GGG-50)
Counterweight	EN-GJS-500-7 (GGG-50)
Bolts and Washers	Stainless Steel A2
Nuts	Stainless Steel A4
Coating inside and outside	epoxy paint potable RESICOAT 9000 R4 BLUE applied electrostatically with thickness $\geq 250 \mu\text{m}$